

# How to measure for ANGLED BAY WINDOWS

## You will need:

A steel tape measure, A pencil, A ruler and 2 pieces of A5 paper

## A 5 STEP GUIDE TO MEASURING ANGLED BAY WINDOWS.

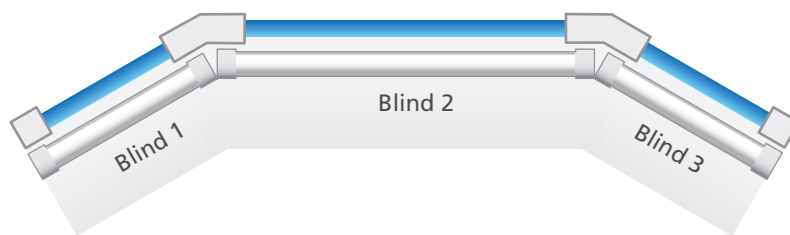

### Step 1

If you have any handles or vents on the windows, measure in millimetres how far out from the window frame they protrude. You'll need to add this measurement to the 'depth' of your blind in the next step.

The 'depth' of your chosen blind type is shown in the table below. This depth is simply the distance your blind will protrude from where it is fitted. You'll need to know this depth to make the correct allowance when measuring.

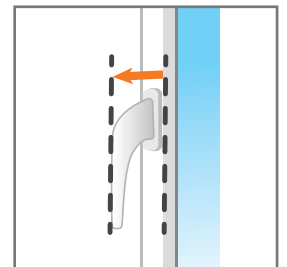

Blind Description	Depth	Single Hung	Depth
Roller Blinds (Face Fix)	70mm	50mm Real & Faux Wood Blinds	65mm
Roller Blinds (Top Fix)	50mm	25mm Aluminium Venetian Blinds	30mm
25mm Real & Faux Wood Blinds	55mm	Roman Blinds	50mm
35mm Real & Faux Wood Blinds	55mm	Vertical Blinds	75mm

Add these two measurements together and note down the result as Dimension 'A'. If there are no handles or any other obstructions on the windows, just use the blind 'depth' as Dimension 'A'.

### Example:

Handle depth = 30mm

Blind depth = 50mm (Roman Blinds)

Dimension 'A' = 80mm

# How to measure for ANGLED BAY WINDOWS

## Step 2

Take your 2 pieces of paper and place them edge to edge. Using a ruler, measure Dimension 'A' from the back edge and make a mark on both pieces of paper.

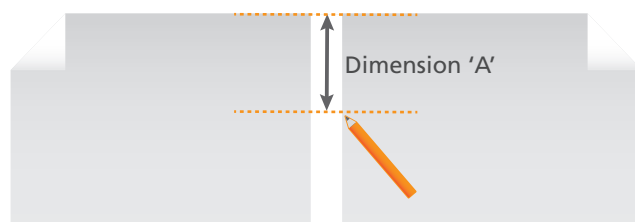

## Step 3

Place the pieces of paper on the window-sill, one either side of the bay window corner and against the window frame. Slide them towards each other until the two marks meet up.

Take the pencil and make a mark on the window-sill at the exact point where the paper meets the window frame. Repeat steps 2 and 3 for each corner of your bay window.

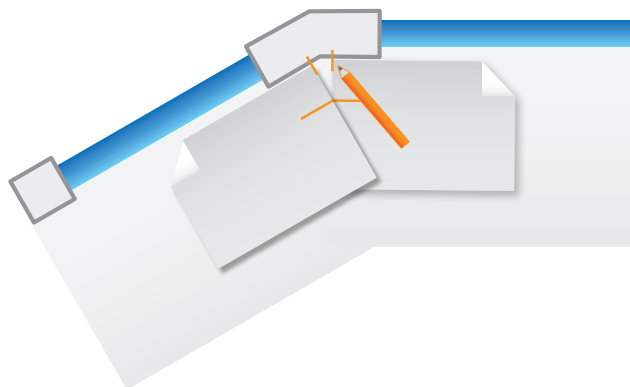

## Step 4

Measure precisely between each set of marks you have made and note these measurements down. These are the 'exact' widths of the blinds you will need to order.

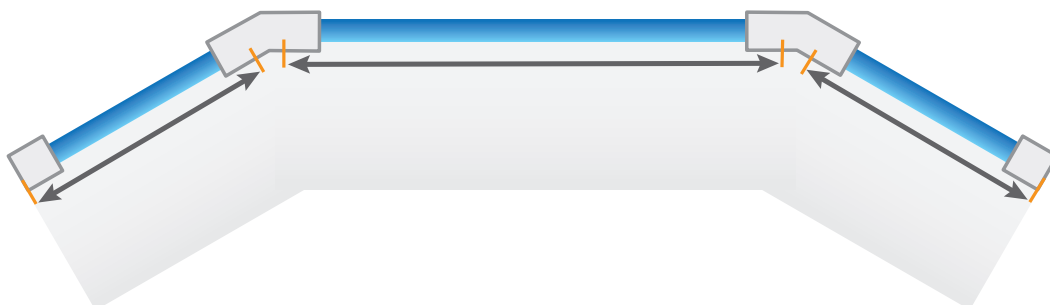

# How to measure for ANGLED BAY WINDOWS

## Step 5

For the drop of your blinds, simply measure from the top of where you want the blinds to fit, down to where you would like the bottom of the blinds to rest (this is usually the window-sill, if you have one). Take this measurement in at least three places across the bay window and use the smallest measurement.

For Vertical Blinds only, reduce this measurement by 12mm to ensure the fabric louvres don't drag or sit on the window-sill.

Note, all of the blinds for your bay window should be ordered as 'Exact Size'.

