

How to measure for SQUARE BAY WINDOWS

Reynolds Top Tip

Firstly, you should note that roller blinds are generally not recommended for square bay windows, unless you have particularly wide corner mullions. This is because the width of the fabric is narrower than the overall width of the blind which means there will be areas of glass that are not fully covered by the fabric. This is particularly noticeable with blackout roller blinds.

You will need:

A steel tape measure, A pencil, A ruler and 2 pieces of A5 paper

A 3 STEP GUIDE TO MEASURING SQUARE BAY WINDOWS.

Step 1

Using a metal tape measure, the width of all three windows directly into the corners. Make sure to check the width at the top, middle and bottom of each window and record the smallest measurement.

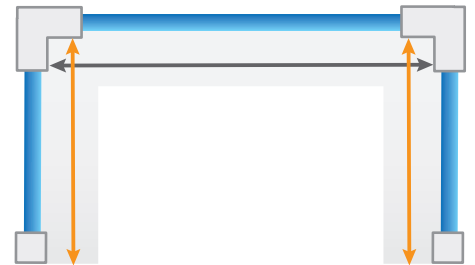

Step 2

If you have any handles or vents on the windows, measure in millimetres how far out from the window frame they protrude. You'll need to add this measurement to the 'depth' of your blind in the next step.

The 'depth' of your chosen blind type is shown in the table below. This depth is simply the distance your blind will protrude from where it is fitted. You'll need to know this depth to make the correct allowance when measuring.

Blind Description	Depth	Single Hung	Depth
Roller Blinds (Face Fix)	70mm	50mm Real & Faux Wood Blinds	65mm
Roller Blinds (Top Fix)	50mm	25mm Aluminium Venetian Blinds	30mm
25mm Real & Faux Wood Blinds	55mm	Roman Blinds	50mm
35mm Real & Faux Wood Blinds	55mm	Vertical Blinds	75mm

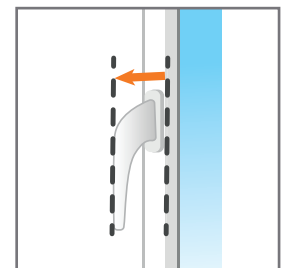

Add these two measurements together and note down the result as Dimension 'A'. If there are no handles or any other obstructions on the windows, just use the blind 'depth' as Dimension 'A'.

How to measure for SQUARE BAY WINDOWS

Example:

Handle depth = 30mm

Blind depth = 50mm (Roman Blinds)

Dimension 'A' = 80mm

Make the Final Deductions for the Width of Each Blind

Centre Blind: Roller Blinds Only:- Deduct 4mm from the Width & Order as 'Exact Size'

Centre Blind: All Other Blinds- Deduct 10mm from the Width & Order as 'Exact Size'

Left Blind: Deduct Dimension 'A' from the Width & Order as 'Exact Size'

Right Blind: Deduct Dimension 'A' from the Width & Order as 'Exact Size'

Step 3

For the drop of your blinds, simply measure from the top of where you want the blinds to fit, down to where you would like the bottom of the blinds to rest (this is usually the window-sill, if you have one). Take this measurement in at least three places across the bay window and use the smallest measurement.

For Vertical Blinds only, reduce this measurement by 12mm to ensure the fabric louvres don't drag or sit on the window-sill.

Note, all of the blinds for your bay window should be ordered as 'Exact Size'.

